

## Check Valves



## Specifications

Nominal Size : 2" ~ 3"

Temperature Rating : -29℃ ~ 121℃ (PU)

Service : Standard

Manufacturing standard : API 6A & NACE MR0175

## Descriptions

Check valves are used in high pressure lines to control one-way flow and prevent fluid from flowing back in pipeline, while protecting the pipe line and equipment safety. The core component of check valve is forged by stainless steel with advanced erosion and abrasion-resistant characteristics. The seals use secondary vulcanization resulting in ultimate sealing.

SLETPETRO can provide top-entry check valves, in-line flapper check valves and dart check valves. Flappers check valves are mainly used in fluid or fluid solid mixture condition. Dart check valves are mainly used in gas or pure fluid with low viscosity condition.



## In-line Flapper Check Valves

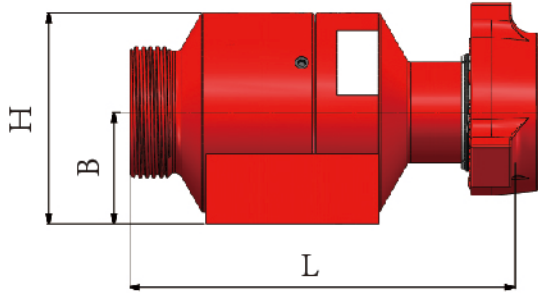

Nominal Size	End Connections		Flow Direction	Rated Working Pressure Mpa/Psi	Dimensions(mm)			Service
					L	B	H	
2"	FIG1502	FXM	Standard	105/15000	358	112	201	Standard
3"	FIG1502	FXM	Standard	105/15000	399	116	219	Standard
3"	FIG2002	FXM	Standard	140/20000	579	192	357	Standard

## In-line Flapper Check Valves Repair Kit

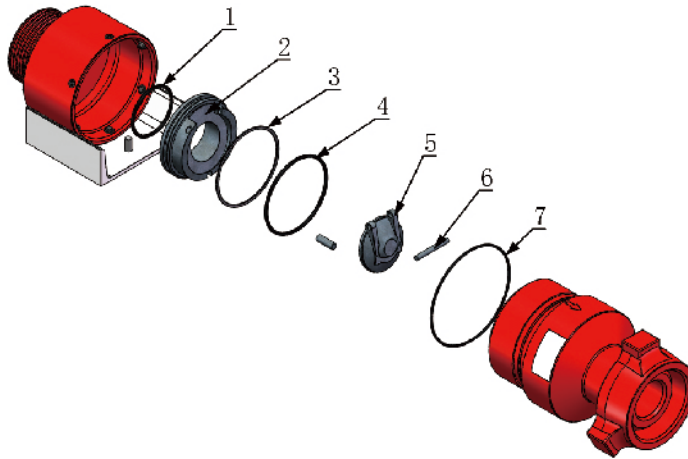

1. O-Ring I
2. Seat
- 3 Backup-Ring II
4. O-Ring II
5. Flapper
6. Pivot Pin
7. Seal III

Nominal Size	Rated Working Pressure Mpa/Psi	O-Ring I	Seat	Backup-Rings II	O-Ring II	Flapper	Pivot Pin	Seal III
2"	105/15000	1	1	1	1	1	1	1
3"	105/15000	1	1	1	1	1	1	1
3"	140/20000	1	1	-	-	1	1	1

## Dart Check Valves

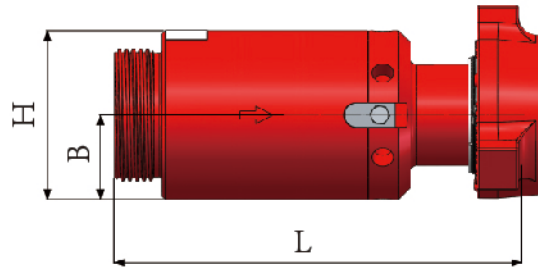

Nominal Size	End Connections		Flow Direction	Rated Working Pressure Mpa/Psi	Dimensions(mm)			Service
					L	B	H	
2"	FIG1502	FXM	Standard	105/15000	318	89	177	Standard
3"	FIG1502	FXM	Standard	105/15000	399	94	188	Standard

## Dart Check Valves Repair Kit

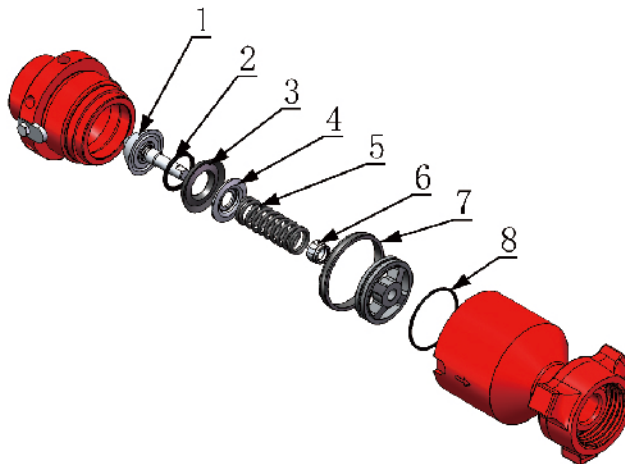

1. Dart
2. O-Rings I
3. Seal I
4. Sealing Plate
5. Spring
6. Lock Nut
7. Seal II
8. O-Rings II

Nominal Size	Rated Working Pressure Mpa/Psi	Dart	O-Ring I	Seal I	Sealing Plate	Spring	Lock Nut	Seal II	O-Ring II
2"	105/15000	1	1	1	1	1	1	1	1
3"	105/15000	1	2	1	1	1	1	1	-